



# FLOOR MACHINES

Parts for P77, P99, P772, P882 and P992

## Model P131

ref#	order	description
	<b>M1400CS</b>	14/3 SJTWA 50' cord with metal strain relief and flag terminal
43	<b>X8207</b>	cord retainer screw (2 req.)
44	<b>X8101</b>	spring washer (2 req.)
45	<b>X8020</b>	axle washer
46	<b>X8022B</b>	handle line cord assembly
47	<b>X8600</b>	switch housing assembly

### NOT ILLUSTRATED

<b>X8108</b>	wheel spacer
<b>X8222</b>	1/4"-20x3/4" socket set screw for X8011 handle
<b>X8590</b>	upper motor bearing
<b>X8536</b>	lower gear box bearing
<b>F3P</b>	motor coupling
<b>SW47</b>	stationary switch
<b>X8210-1</b>	short switch housing screw and nut
<b>X8220</b>	long, switch housing screw

## Standard Gear Box Assembly

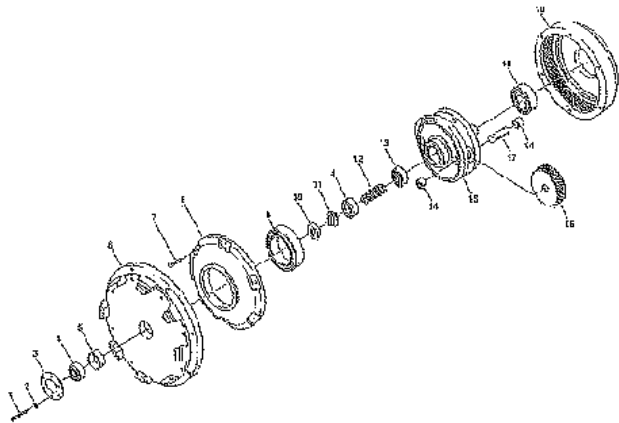

## Models P171, P171HD, P171SD, P172, P173, P201, P201HD, P202, and P203 Polishers (ref. part 30A pg 103)

ref#	order	description
1	<b>X8594</b>	screw, socket head cap
4	<b>X8590</b>	bearing
5	<b>X8595</b>	spacer, sleeve
10	<b>X8592</b>	retainer
11	<b>F3P</b>	coupling
12	<b>X8591</b>	gear, pinion
14	<b>X8095</b>	bearing, needle
16	<b>X8094</b>	gear, idler
19	<b>X8093</b>	housing, drive

## Models P77, P99, P772, P882 and P992

<b>F1P</b>	switch triggers (pair), all models
<b>F3P</b>	coupling, all models
<b>F5P</b>	switch, all models
<b>F8P</b>	wheel, large, non-marking, all models
<b>F9P</b>	hub caps for wheel, all models
<b>F11P</b>	cable strain relief, steel, all models
<b>F19P</b>	motor complete, P992, P772
<b>F21P</b>	rotary switch, all models
<b>F27P</b>	switch box front, all models
<b>F28P</b>	rear wheel for P882
<b>F30P</b>	hand grip, all models
<b>M1369A</b>	14/3 STWA 50'yellow cord7
<b>F32P</b>	switch box closing screws, all models
<b>F33P</b>	handle tube screws, all models
<b>F37P</b>	bumper guard for P99, P992
<b>F39P</b>	sliding collar, all models
<b>F40P</b>	drive belt for P882
<b>F41P</b>	bearing block assembly complete, all models
<b>F42P</b>	pulley driver for P882
<b>F45P</b>	pad holder, yellow
<b>F47P</b>	cam wing nut
<b>F50P</b>	pad holder for P882, black, "snap on" type
<b>F70P</b>	2-wire tug cable, all models
<b>X8101</b>	spring washer, all models
<b>X8010</b>	trigger spring return, all models
<b>F77P</b>	trigger pins, all models
<b>F78P</b>	switch box back, all models
<b>F79P</b>	strain relief clip P882
<b>X8201</b>	switch mount plate screw, all models
<b>X8006</b>	switch mount plate, all models
<b>F85P</b>	wheel axle cotter pin, all models
<b>F86P</b>	wheel washer, all models
<b>F88P</b>	*oil capacitor P772, P882
<b>F89P</b>	*start capacitor P772, P99, P992
<b>F99P</b>	handle tube and yoke, all models
<b>F104P</b>	yoke, all models
<b>X8012A</b>	handle clamp assy
<b>X8013</b>	cable hook

**NOTE: Must have MFD number off of old oil capacitor and start capacitor to match properly.**



# FLOOR MACHINES

## Parts for P-SERIES MACHINES

### Models P171, P171HD, P171SD, P172, P173, P201, P201HD, P202, and M203 Polishers

ref#	order	description
1	<b>X8001</b>	top handle housing
2	<b>X8002</b>	bottom handle housing
3	<b>X8003</b>	switch lever
4	<b>X8004</b>	ball
5	<b>X8005</b>	handle tube
6	<b>X8006</b>	switch bracket
7	<b>X8007</b>	handle grip (2 req.)
8	<b>X8008</b>	strain relief, plastic
8	<b>SR42</b>	strain relief, metal
8A	<b>X8008N</b>	nut for X8008 and SR42
8B	<b>X8551</b>	3/4" washer
8C	<b>SR42A</b>	brass sleeve for SR42 strain relief
9	<b>X8026</b>	dowell pin (2 req.)
9A	<b>X8110</b>	spring, dowell pin (2 req.)
10	<b>X8061</b>	clip switch lever
11	<b>X8011B</b>	handle tube 1-1/2" w/bushings
12A	<b>X8012</b>	handle clamp collar
12B	<b>X8028</b>	square washer
12	<b>X8012A</b>	handle clamp assembly
13	<b>X8013</b>	cord hook
15	<b>X8210</b>	wheel screw, short switch housing screw
16	<b>X8016</b>	knob
17	<b>X8017L</b>	left brace
18	<b>X8017R</b>	right brace
19	<b>X8018-1</b>	pivot shaft
20	<b>X8019</b>	axle
21	<b>X8201</b>	8/32"x3/8" type F screw (2 req.)
22	<b>X8010</b>	switch spring
23	<b>X8009</b>	4" jumper wire
24	<b>X8024</b>	5" wheel
25	<b>X8202</b>	mount bolt
26	<b>X8150M</b>	mount for capacitor strap
27	<b>X8030</b>	46" bumper for 20" machine
	<b>X8030B</b>	36" bumper for 17" machine
29	<b>X8150</b>	capacitor strap
30	<b>X8035</b>	1-1/2 HP motor w/o gear unit P171HD, P171SD, P201HD, P203,P173
30	<b>X8035HD</b>	1-1/2 HP 175RPM motor with gear unit for P171HD, P171SD, P201HD
30	<b>X8035-3</b>	1-1/2 HP 300 RPM motor with gear unit for P173, P203
30	<b>X8045</b>	1 HP motor w/o gear unit P201, P171
30	<b>X8045-1</b>	1 HP 175 RPM motor with gear unit for P171, P201
30	<b>X8071</b>	2 speed 1-1/2 HP motor assembly for P202, P172
30A	<b>X8072</b>	300 RPM gear unit for P173, P203
30A	<b>X8073</b>	175 RPM gear unit for P171, P171HD, P201, P201HD
32	<b>X8042</b>	motor cover
31,33	<b>X8040</b>	590 MFD, 110V start capacitor for Doerr 1 HP 175 RPM motor
31,33	<b>X8046</b>	35 MFD 240V run capacitor for Doerr 1-1/2 HP Doerr Model #R07559 & G51400
31,33	<b>X8056</b>	310 MFD 125V start capacitor for 1 1/2 HP Doerr Model #R07559 & G51400
34	<b>X8207</b>	motor ground screw P171, P202

ref#	order	description
35	<b>X8052</b>	base housing, 20"
35	<b>X8053</b>	base housing, 17"
37	<b>X8225</b>	3/16" cut washer
38	<b>X8023</b>	15 amp circuit breaker,P171, P131,P201
38	<b>X8023A</b>	17 amp circuit breaker, P173, P203, P171HD P201HD, P172, P202
39	<b>F5P</b>	switch-25 AMP
40	<b>M1369A</b>	14/3 SJTWA 50' yellow cord
40A	<b>M1369AS</b>	14/3 STWA 50' yellow cord assembly with metal strain relief & flag receptical
41	<b>X8208</b>	10-24x5/8" phillips head machine screw
42	<b>X8219</b>	3/8" SAE flat washer
43	<b>X8218</b>	5/16" SAE flat washer
44	<b>X8212</b>	1/4" spring washer
45	<b>X8211</b>	1/4"-20x1 hex head cap screw
46	<b>X8101</b>	spring washer
47	<b>X8108</b>	wheel spacer
48	<b>X8020</b>	axle washer
49	<b>X8207</b>	cord retainer screw
50	<b>X8022B</b>	17" and 20" cord assembly (handle)
	<b>X8022E</b>	handle cord, P172, P202 only
51	<b>X8600</b>	switch housing assembly comes with X8023 (except P171 & P201 require X8023A)

#### NOT ILLUSTRATED

	<b>X8213</b>	nut for X8210-1
	<b>X8222</b>	1/4"-20x3/4" socket set screw for X8011 handle
	<b>SW47</b>	motor start switch, small 1 pr. contacts all 1 & 1 HP Howell
	<b>SW48</b>	motor start switch, large, 2 pr. contacts 1-1/2HP Howell
	<b>PX28</b>	insulator boot for P202, P172 toggle switch
	<b>SB17</b>	sand paper driver for P171SD
	<b>SW46</b>	stationary switch, small, 2 pair contacts fits Howell 1 HP, Doerr 1-1/2 HP
	<b>SW39</b>	20 mp toggle switch for P202, P172
	<b>X8034-2</b>	50 amp, 60 cycle rectifier for P202, P172
	<b>X8512</b>	carbon brush P202, P172 (4 req)
	<b>X8526</b>	rotating switch for 1 & 1 1/2 HP Doerr
	<b>X8530</b>	2 speed control for P202, P172
	<b>F3P</b>	motor coupling
	<b>T2095</b>	203 motor bearing
	<b>X8220</b>	long, switch housing screw
	<b>X8210-1</b>	short switch housing screw & nut